

Rural Municipality of Loreburn No. 254

Bylaw No. 15/2024

A BYLAW TO PROVIDE FOR THE NUMBERING OF HOUSES AND OTHER BUILDINGS IN LAKESIDE RV TRAILER PARK LTD. PHASE 1, 2,3 AND 4

The council of the Rural Municipality of Loreburn No. 254, in the Province of Saskatchewan, enacts as follows:

1. This bylaw shall be referred to as the Civic Addressing Bylaw.
2. A uniform system of numbering houses and other buildings is hereby established and is shown on the attached map identified as Schedule "A", and the attached map identified as Schedule "B", appended hereto and forming a part of this bylaw.
3. A separate number shall be assigned for each frontage.
4. Each house or building shall bear the number assigned to the frontage on which the front entrance is situated.
5. Notwithstanding section 4 of this bylaw, upon request of the owner of a property situated on a corner, the number assigned may be specific to the flankage.
6. In case a house or building is occupied by more than one family dwelling unit, each separate front entrance of said house or building shall bear a separate number.
7. Numerals indicating the official number of each house or building or each front entrance shall be posted in a manner as to be visible from the street on which the property is located.
8. The Administrator shall be responsible for maintaining the numbering system and shall keep a record of all numbers assigned under this bylaw.
9. Any person who contravenes the provisions of this bylaw is guilty of an offence and upon conviction shall be liable as per the General Penalty Bylaw.
10. Bylaw No 14/2023 shall be hereby repealed.

SEAL



[Handwritten Signature]
REEVE

[Handwritten Signature]
ADMINISTRATOR

Introduced and read a first time this 20th day of August, 2024.
 Read a second time this 20th day of August, 2024.
 Read a third time this 20th day of August, 2024.
 Adoption of this bylaw this 20th day of August, 2024.

"Certified to be a true copy of Bylaw No. 15/24 adopted by the council of the Rural Municipality of Loreburn No. 254

on the 20th day of August, 2024."



[Handwritten Signature]
Administrator

LAKESIDE RV TRAILER PARK (NE 02-25-05 W3)

SCHEDULE "A"

Lakeside Road

Lot #	Plan #	Address #
BL 1		
19B	101952301	101
19A	101952301	102
18	101909460	103
17	101909460	104
16	101909460	105
15	101909460	106
14	101909460	107
13	101909460	108
12	101909460	109
11	101909460	110
10	101909460	111
9	101909460	112
8	101909460	113
7	101909460	114
6	101909460	115
5	101909460	116
4	101909460	117
3	101909460	118
2	101909460	119
1A	102086771	120
20	102086771	121
21	102086771	122
22	102086771	123
23	102086771	124
24	102086771	125
25	102086771	126
26	102086771	127
27A	102260595	128
28A	102260595	129
29A	102260595	130
BL 2		
21	102368875	214
16	102086771	215
18A	102300107	218
19A	102300107	219
20	102300107	220
BL 10		
16	102300107	535
17	102300107	536
18	102300107	537

18	102086771	506
19	102086771	507
20	102086771	507A
21	102086771	508
22	102086771	509
23	102086771	510
24	102086771	511
25	102086771	512
26	102086771	513
27	102086771	514
28	102086771	515
29	102086771	516
30	102086771	517
31	102086771	518
32	102086771	519

BL 10

1	102300107	520
2	102300107	521
3A	102430156	522
5	102300107	524
6	102300107	525
7	102300107	526
8	102300107	527
9	102300107	528
10	102300107	529
11	102300107	530
12	102300107	531
13	102300107	532
14	102300107	533
15	102381959	534

BL 6

1	102086771	401
2	102086771	402
3	102086771	403
4	102086771	404
5	102086771	405
6	102086771	406
7	102086771	407
8	102086771	408
9	102086771	409
10	102086771	410
11	102086771	411
12	102086771	412
13	102086771	413

BL 9

1	102300107	414
---	-----------	-----

BL 9	9	102086771	317
	24	102300107	437
	23	102300107	436
	22	102300107	435
	21	102300107	434
	20	102300107	433
	19	102300107	432
	18	102300107	431
	17	102300107	430
	16	102300107	429
	15	102300107	428
	14	102300107	427

RV Way

Lot#	Plan #	Address#	
BL 3			
	1	102086771	141
	2	102086771	142
	3	102086771	143
	4	102086771	144
	5	102086771	145
	6	102086771	146

RV Road

Lot#	Plan #	Address#	
BL 3			
	12	102086771	151
	11	102086771	152
	10	102086771	153
	9	102086771	154
	8	102086771	155
	7	102086771	156

Claire's Road

Lot#	Plan #	Address#	
BL 11			
	1	102407149	710
	2	102407149	711
	3	102407149	712
	4	102407149	713
	5	102407149	714
	6	102407149	715

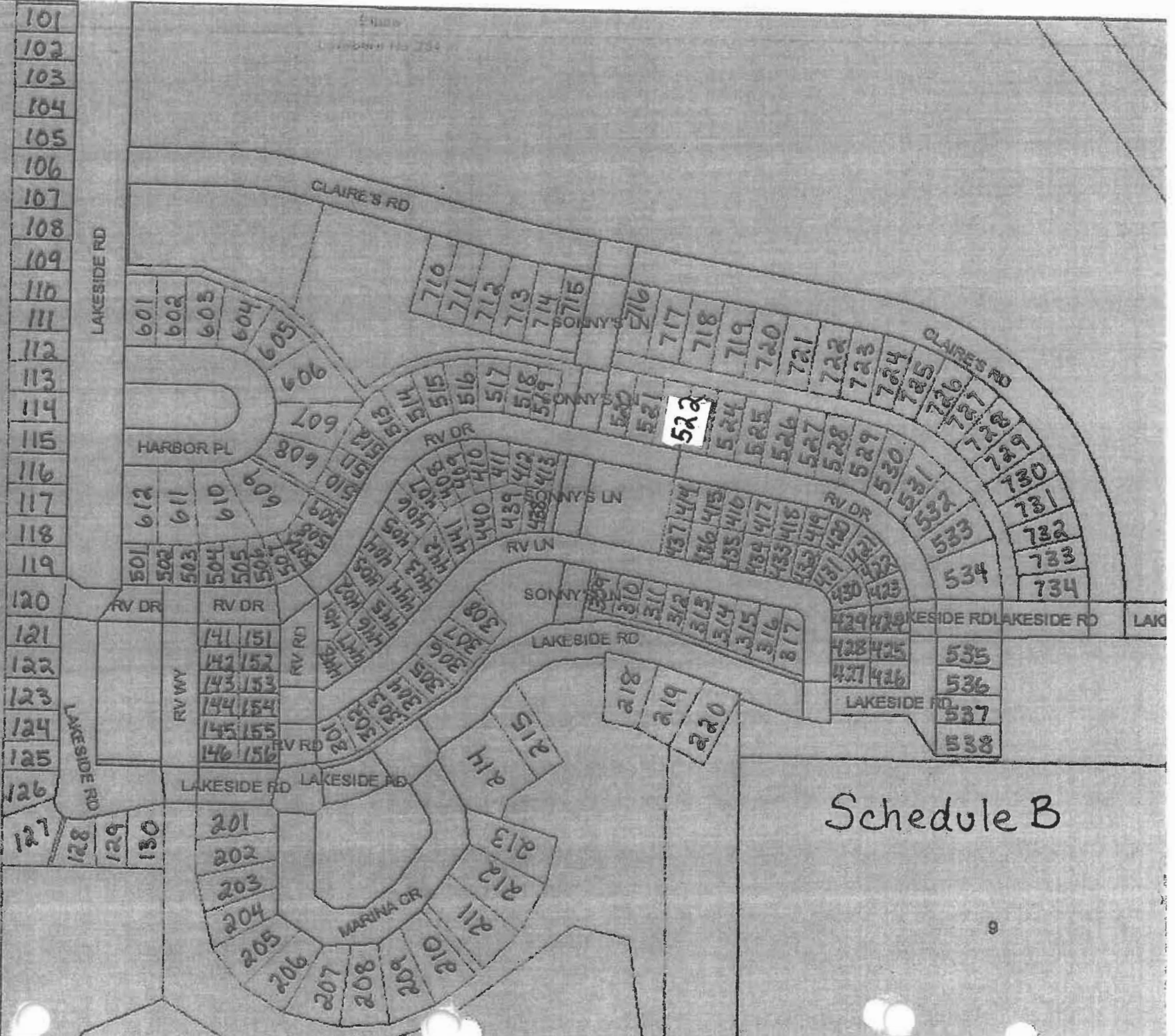

Schedule B