

## Rural Municipality of Loreburn No. 254

Road Construction Project starting on  
Tuesday, October 10, 2023

The project is taking place at Lakeside RV Development and will affect Range Road 3051, the south back entrance into Elbow.

All residents along this road will still have access to their homes but there won't be any thru traffic allowed.

From Highway 19 you will not be able to get into the Village of Elbow.

From the Village of Elbow you will not be able to get to Highway 19.

Signs will be posted on the route.

Attached are two pictures showing the work area and the route that will be affected.

Any questions let the RM office know and thank you for your cooperation!

# Lakeside Second Access

Legend

N51°06'33.12"

Mud  
Area



Google Earth

Image © 2023 Airbus



# Range 5

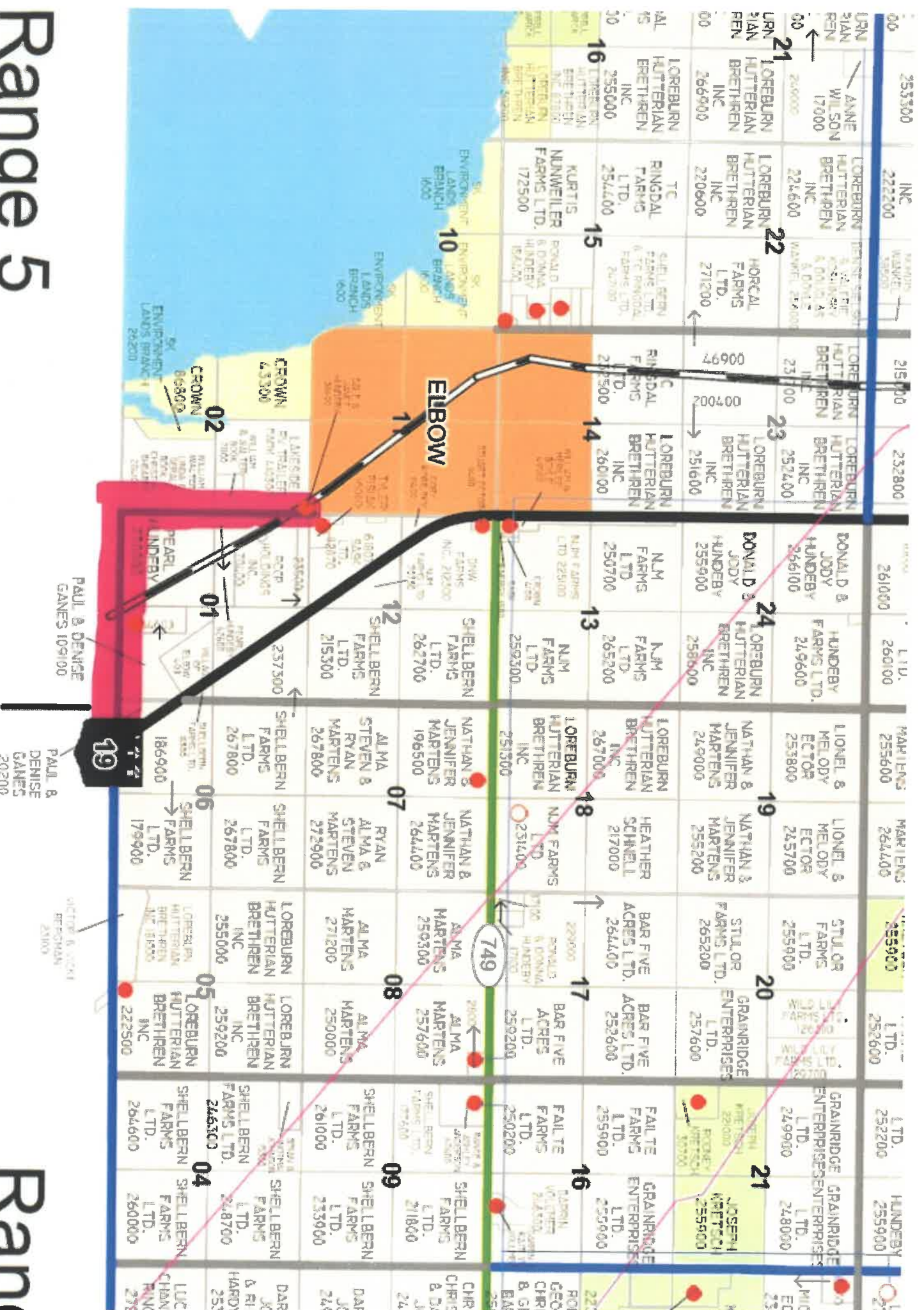

# Range 6